

SYSTEM DEFINITION SHEET

Lucent - Murray Hill - SAWS
 Top Assy, 1091458.1
 VSA Job #: 39594
 Project Engineer: Jane Campbell
 TSS 520

Program Coordinator:

REVI DATE/ APPROVED: SCOPE OF CHANGE:

6/19/98, JEC	Initial
7/1/98, JEC	Incorporate customer kickoff notes
7/30/98, JEC	Correct custom # for "fill type; move light tree information, added power
8/12/98, JEC	Change to 12:1 aspiration, remove DI flush

BENCH DEFINITION

Input Cassette Size / Part #	1X200MM, 8"	Decktop/Lip Exhaust		SAWS Dm Ex. (Bottom/Rear)	REAR, 2"	No. of Doc. Copies:	3
H-Bar Orientation Facing: (Operator/Back/Custom*)	Out/H-Bar is opposite arm	Headcase Purge (Y/N)	NO	Main Power (volts / amps)	120/208, 3phase, 40 amp	No. of Cleanroom copies:	1
Process Cassette Size / Part #	Same EMPAK XP201-0200	Drains (Thread/ Fuse)	THREAD	UPS Power (volts / amps)	NO	No. of Plain Paper copies:	2
Host Interface (No / SECS II / GEM)	SECS II	Plenum Spray (Yes / No)	NO	Bulkhead / Ballroom	BALLROOM	Mfr's Literature	1
Mini-Environment (Yes / No)	NO	Glove Wash (Yes / No)	NO	WTU (Moving Head/Table/No)	NA	New Calib Required? Y/N	NO
Fire Detect/ Suppress (Yes/No / Yes-No)	NO	EMO on Exhaust Fan (Y/N)	YES	N ₂ Connection (Swage/VCR)	SWAGE	If "Y" Add to Custom	NA
Fire System Piping (Threaded / Compression)	NA	Photohelic Range	STATIC, 0-2.0"	Riser Blocks		New Op Instr Req'd? Y/N	NO
DI Spray Gun (Front / Rear / Both)	BOTH	SAWS Light Tree (Yes/No)	YES			If "Y" Add to Custom	NA

MODULE DEFINITION

FEATURE:	Module #1
Module Name	HOT PHOS/QDR
Module Construction (FRPP / WPP / SST)	HALAR (CUSTOM #1)
Module Width (inches)	40"WX58"D
Robot Chase (Exhausted / Vented)	EXHAUSTED
Exhaust Exit (Bottom / Top)	BOTTOM, 8"
DI Reclaim (Yes / No)	YES (CUSTOM #2)

PROCESS DEFINITION

Process Name	HOT PHOS
Tank Name / Number	HOT PHOS #1
Process Sequence Number	1
Process Ratio (Chem 1 : Chem 2 : Chem 3)	
CHEM 1: (Name)	HOT PHOS
Concentration (xx : 1 / Premix)	Premix/100%
Fill Type (Manual / Bulkfill)	Manual (Custom #3)
Bulkfill Call Signal (signal or contacts)	Contact
Auto-Replenish (Yes / No)	NO (Custom #3)
POU Filter (Yes / No)	NO
Spiking (Yes / No/ Frequency)	NO
Staging (Yes / No)	NO
Temp (°C / Ambient)	AMBIENT
CHEM 2 (Name / N/A)	DI H2O INJECTION
Concentration (xx : 1 / Premix)	
Fill Type (Manual / Bulkfill)	
Bulkfill Call Signal (signal or contacts)	
Auto-Replenish (Yes / No)	
POU Filter (Yes / No)	
Spiking (Yes / No/ Frequency)	
Staging (Yes / No)	
Temp (°C / Ambient)	AMBIENT
Process Temperature (°C / Range)	170 C, 140-170 C +/- 2 C
Bath Temp Control (Blanket/ Line/ H-C)	Blanket
Tank Material	Quartz
Manufacturer	Imtec
VSA PN# Eimp L	
Megasonic (Yes / No)	NO

Dispersion Plate (Yes / No)	NO
Programmable DI Flush (Yes / No)	NO
Agitation (Period / Amplitude)	NO
Process Time Range (Min to Max)	
Bath Life (Min to Max)	
Recirculation (Yes / No)	NO
Filtration (Housing Size / Pore Size [µ])	NO
Dedicated Chemical Drain (Yes / No)	YES
Aspiration (Ratio / Exit Temp)	12:1/70 C/15-25 MIN
Cool Down Box (Yes / No)	NO
Cool Down Specs (Time / Exit Temp)	NA
Fill Receptacle (Yes / No)	NO

QDR/OFR/EE WASH DEFINITION

Process Name	DI H2O
Tank Number	2
Process Temp. (C / Ambient)	AMBIENT
Hot DI Water (Facility / Stand Alone / N/A)	NO
Temperature Monitoring (Yes / No)	NO
Tank Material	PVDF
Manufacturer	VPS
VSA PN	
QDR / OFR / EE	QDR
Megasonic (Yes / No)	YES/STOD800-CC50-MC
Lid (Yes / No)	NO
Rinse to Resistivity (Yes / No)	YES, 10 megohms(Cust #4)
High/Low Flow Plumbing (Yes / No)	YES
Filtration (Housing Size / Pore Size [µ])	NO
Spiking (Chemistry/ Source/ Stage Tank?)	NO

CUSTOM FEATURES:

Custom #1: HALAR SHELL, PVDF DECKS

Custom #2: PVDF

Custom #3: Bulkfill ready; autoreplenish can be activated for bulkfill

Custom #4: Change to sales order pending to include rinse to resistivity

Custom #5:

Custom #6:

Custom #7:

Custom #8:

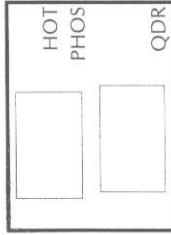

Module #1

SIZE/DWG. NO. 1091458

2

3

4

REVISIONS	

NOTES	
1.)	CELL CONTROLLER MUST BE LOCATED WITHIN 8 FEET OF MODULE

UNLESS OTHERWISE SPECIFIED DIMENSIONS ARE IN INCHES	
.XX DECIMALS	± .03
.XXX DECIMALS	± .010
FINISH	32
TOLERANCES ON:	
"X" ±	1"
1/4" ±	1/32"
1/2" ±	1/16"

DATE	BY	DATE
07/31/98	G. AQUINO	07/31/98
07/31/98	G. AQUINO	07/31/98

APPROVED:	DATE
G. WARNER	07/31/98

VERTIQ SYSTEMS AUTOMATION
CORVALLIS, OR

TOP ASSEMBLY
SAWS, PHOS STATIC
LUCENT 39594

SIZE/SCALE: B | 1 : 1 | 16 | SH: 1 OF 1

- 3 ASSEMBLY, ELECTRICAL, PLC-1 TO CTI-CA
- 4 ASSEMBLY, ELECTRICAL, ROBOT TO CTI-CA
- 5 FACILITY LAYOUT
- 6 BENCH SOFTWARE
- 7 PLC CODE
- 8 ELECTRICAL SPECIFICATION PLATE

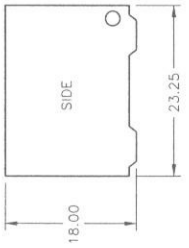
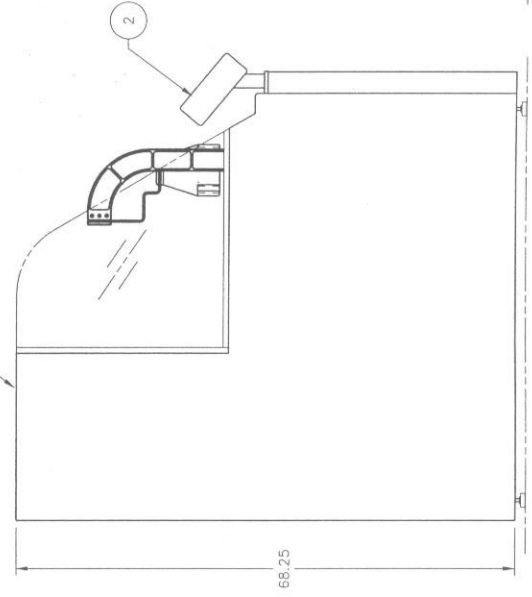
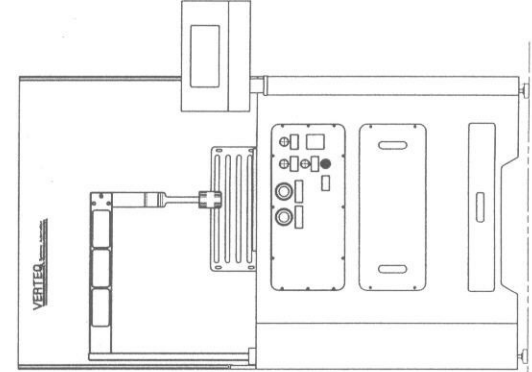
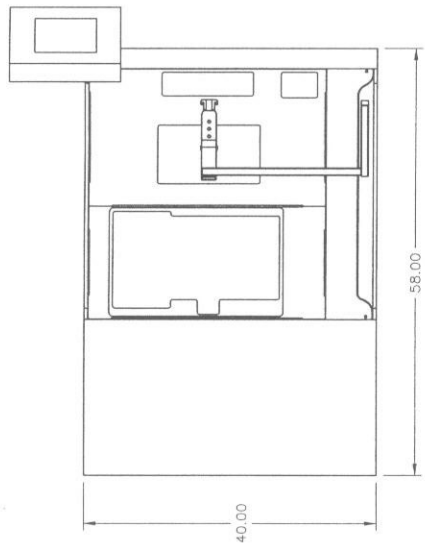

CELL CONTROLLER

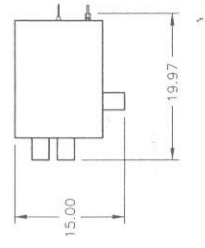

DI RECLAIM VALVE BOX

D

C

B

A

4

3

2

1

