

PROPRIETARY NOTICE

This document discloses confidential subject matter in which MilesTek Corporation and its subsidiaries have proprietary rights. Neither receipt nor possession thereof confers or transfers any right to reproduce or disclose the document, any part thereof, any information contained therein, or any physical article or device, or to practice any method or process, except by written permission from, or written agreement with MilesTek Corporation and its subsidiaries.

REVISIONS			
REV	DESCRIPTION	DATE	APPROVED
A	INITIAL RELEASE	06/01/17	J.YOU

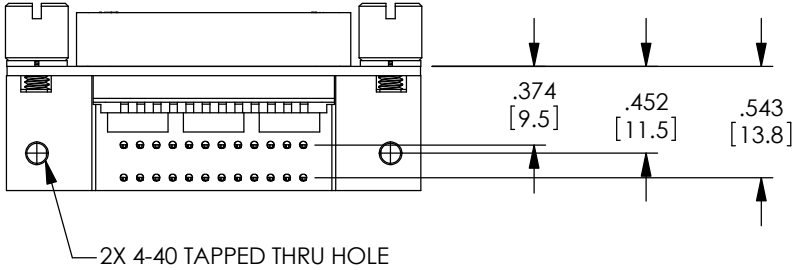
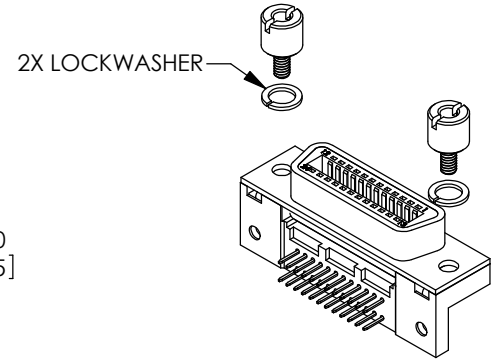
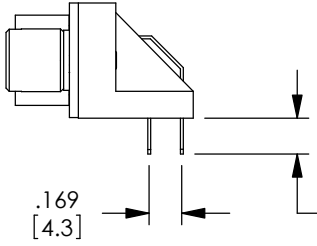
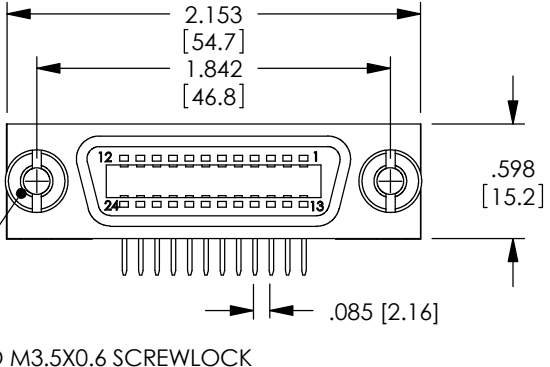

RECOMMENDED PCB HOLE LAYOUT

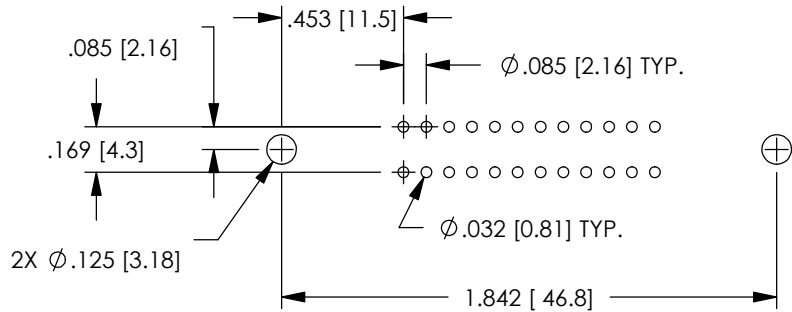

- NOTES:
- MATERIALS:  
SHELL: STEEL  
CONTACTS: PHOSPHOR BRONZE  
INSULATOR: BLUE POLYBUTYLENE TEREPHTHALATE (PBT)  
U.L. 94V-0 RATED
  - FINISHES:  
CONTACTS: GOLD PLATED  
TERMINALS: TINNED  
SHELL: NICKEL PLATED  
SCREWLOCKS: BLACK OXIDE
  - SUPPLIED WITH HARDWARE ASSEMBLED.
  - TYPICAL OPERATING VOLTAGE IS 30 VOLTS.
  - MAXIMUM VOLTAGE RATING IS 500 VOLTS.
  - COMPONENT SHALL BE INDIVIDUALLY PACKAGED IN ACCORDANCE WITH SPEC. PS-0054.

NON CONTROLLED DRAWING IF PRINTED

AS9100C CERTIFIED			CAD SYSTEM DRAWING - DO NOT REVISE MANUALLY			
DASH	NEXT ASSY	USED ON	UNLESS OTHERWISE SPECIFIED ALL DIMENSIONS ARE IN INCHES	SIGNATURE	DATE	 MILESTEK CORPORATION 1506 INTERSTATE 35 WEST DENTON, TX 76207 PHONE: 866.524.1553 FAX: 940.591.7086
			OVERALL CABLE LENGTH TOLERANCE: ≤12 [305] = +1 [25] / -0 >12 [305] ≤60 [1524] = +2 [51] / -0 >60 [1524] ≤120 [3048] = +4 [102] / -0 >120 [3048] ≤300 [7620] = +6 [152] / -0 >300 [7620] = +5% / -0%	DRAWN BY: J.YOU 06/01/17	DATE: 06/01/17	
			ALL OTHER DIMENSIONAL TOLERANCES: .X = ±.2 [5.08] .XX = ±.02 [5.1] .XXX = ±.005 [1.3]	CHECKED BY: Brian G. 06/01/17	APPROVED ENGINEERING: S.PAN 06/01/17	TITLE
			CUSTOMER REFERENCE DOCUMENT:	CUSTOMER APPROVAL		IEEE-488 SOCKET, RT. ANGLE PC TERMINALS
			APPLICATION	CAGE CODE: 42977		SIZE: <b>A</b> DRAWING NUMBER: MGPB00003
						SCALE: NTS SHEET 1 OF 1

REGULATORY COMPLIANCE:  
CE2011/65/EU(RoHS DIRECTIVE)