

DIN 41618

**Technical data**

Pincount	16
Gender	Female
Material contact	Copper alloy
Plating contact	Ag
Material insulator	Thermoplast UL94V-0
Rated current IEC	10,0 A
Rated voltage	250 V RMS / V DC
Withstand voltage	875 V RMS for 1 Minute
Operating temperature	-55°C to +125°C
Max. processing temper.	230°C for 5 seconds
Board termination	Through hole
Orientation to PCB	Parallel, Vertical
No of rows	2
Leading contacts	---
Packaging	Standard
A	59,00
B	41,00
C	50,00
D	50,00
E	42,00
F	5,00

Pincount	A	B	C	D	E	F
010	47,00	29,00	38,00	38,00	30,00	5,70
016	59,00	41,00	50,00	50,00	42,00	5,00
020	71,00	53,00	62,00	62,00	54,00	5,20
026	83,00	65,00	74,00	74,00	66,00	4,90

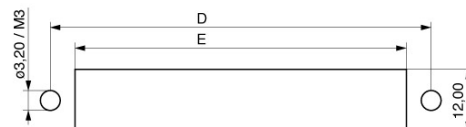
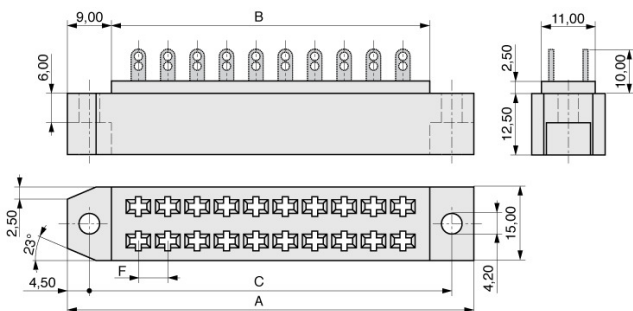

## Ordering number configuration

Pincount: 16

711-1--HAN-ES

383

710



MPE Garry GmbH  
Schäfflerstraße 13  
87629 Füssen/Germany

Telefon: +49 (0) 83 62 / 91 56-0  
Fax: +49 (0) 83 62 / 91 56-500  
E-Mail: [vk@mpe-connector.de](mailto:vk@mpe-connector.de)

Creation date: **24.04.2024**, Internet: <https://www.mpe-connector.de/en/products/din-41622-41618/socket-connector-din-41618/711-1#711-1-016-HAN-ES>