

DIN 41622

**Technical data**

Pincount	16
Gender	Female
Material contact	Copper alloy
Plating contact	Au 0,8 µ
Material insulator	Thermoplast UL94V-0
Rated current IEC	10,0 A
Rated voltage	250 V RMS / V DC
Withstand voltage	875 V RMS for 1 Minute
Operating temperature	-20°C to +85°C
Max. processing temper.	230°C for 5 seconds
Board termination	Through hole
Orientation to PCB	Parallel, Vertical
No of rows	2
Industry standard	DIN 41622
Leading contacts	---
Packaging	Standard
A	71,00
B	53,00
C	62,00
D	54,00

Pincount	A	B	C	D	D
008	47,00	29,00	30,00	30,00	30,00
012	59,00	41,00	50,00	42,00	42,00
016	71,00	53,00	62,00	54,00	54,00
020	83,00	65,00	74,00	66,00	66,00

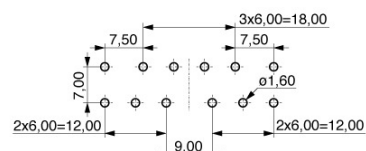
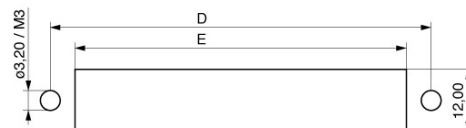
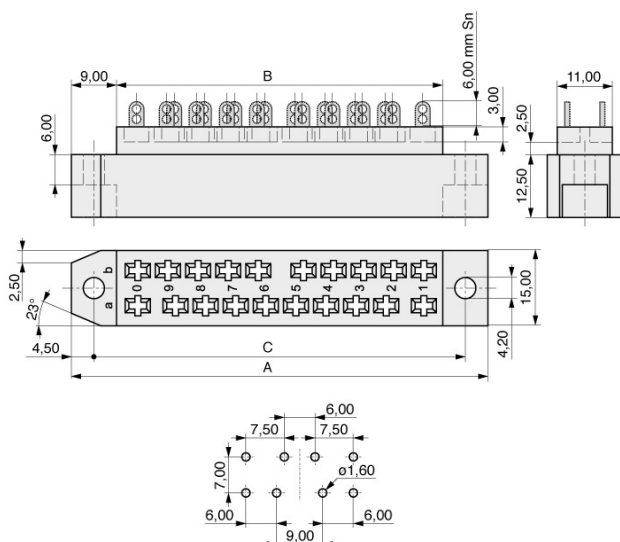

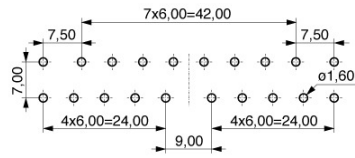
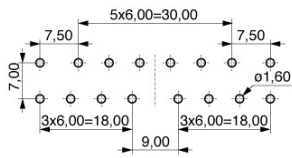

### Ordering number configuration

384-1-XXX-XXN-ZS

- Pincount: 16
- Contact type DIN 41622/41618: 10 mm
- Plating contact: Au 0,8  $\mu$

	383	710																	
--	-----	-----	--	--	--	--	--	--	--	--	--	--	--	--	--	--	--	--	--

	<p>MPE Garry GmbH Schäfflerstraße 13 87629 Füssen/Germany</p>	<p>Telefon: +49 (0) 83 62 / 91 56-0 Fax: +49 (0) 83 62 / 91 56-500 E-Mail: <a href="mailto:vk@mpe-connector.de">vk@mpe-connector.de</a></p>
<p>Creation date: 24.04.2024, Internet: <a href="https://www.mpe-connector.de/en/products/din-41622-41618/socket-connector/384-1#384-1-016-GKN-ZS">https://www.mpe-connector.de/en/products/din-41622-41618/socket-connector/384-1#384-1-016-GKN-ZS</a></p>		